

AutoCross-Laser 2 Plus

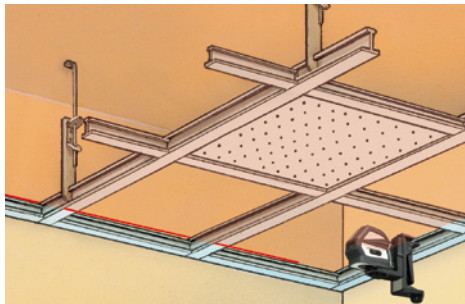

Cross-line laser with 2 clearly visible laser lines and integrated hand receiver mode

Rev.0316

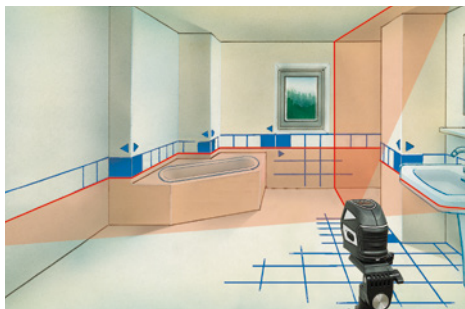
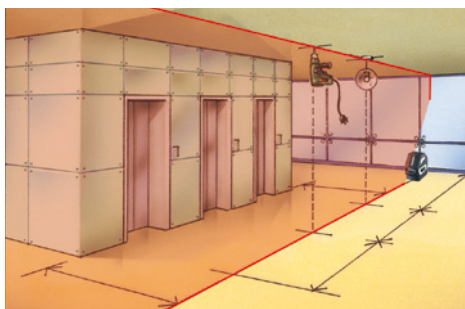

- **PowerBright-Laser⁺**: Special high-performance laser diodes project extremely visible laser lines.
- This unit produces **2 very visible laser lines** which make it outstanding for the alignment of tiles, wall studding, windows, doors, etc.
- The **magnetic wall bracket** allows the unit to be used as a stand-alone device or in combination with other devices – on walls and attached to magnetic objects
- Ideal for **mounting on drywall construction profiles**
- **Automatic Level**: automatic alignment by virtue of a magnetic pendulum system.
- **Tilt mode is an additional feature** that permits gradients to be laid out.
- **Individually switchable** laser lines.
- **Out-Of-Level**: is indicated by optical signals when the unit is outside its self-levelling range.
- **RX-Ready**: The integrated hand receiver mode detects the laser lines with the optional laser receiver RX up to a max. of 40 m radius – ideal for all interior and exterior applications.
- **Transport lock**: A pendulum lock protects unit during transport.
- **Simple, uniform operating techniques.**

TECHNICAL DATA

ACCURACY	2 mm per 10 m
SELF-LEVELLING RANGE	± 3°
LEVELLING	automatic
LASER WAVELENGTH	635 nm
LASER	line lasers, class 2 < 1 mW
POWER SUPPLY	3 x 1,5V type AA, approx. 20 hrs operating time
WORKING TEMPERATURE	0°C ... +50°C
STORAGE TEMPERATURE	-10°C ... +70°C
WEIGHT	incl. batteries 0,5 kg
DIMENSIONS	115 x 95 x 65 mm (W x H x D)

1H 1V

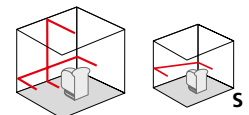

AutoCross-Laser 2 Plus

including carrying case
+ magnetic wall bracket
+ batteries

Packing dimension (W x H x D)
340 x 275 x 85 mm

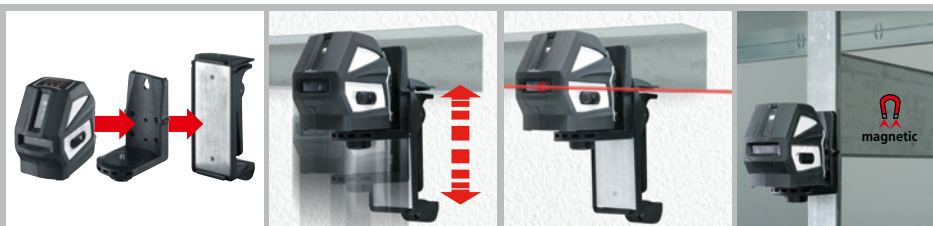

Stand-alone device or in combination: wall- and clamp holder

Height and position of the measuring device easily adjustable

Anchorage point and laser level at one height

Magnetic

ARTICLE	ARTICLE NO	EAN-CODE	PU
AutoCross-Laser 2 Plus	032.101A	4 021563 688722	1

