

Laserliner

MultiFinder Plus



Universal detector for locating wood, metal, copper, iron and live wires

Rev18W38

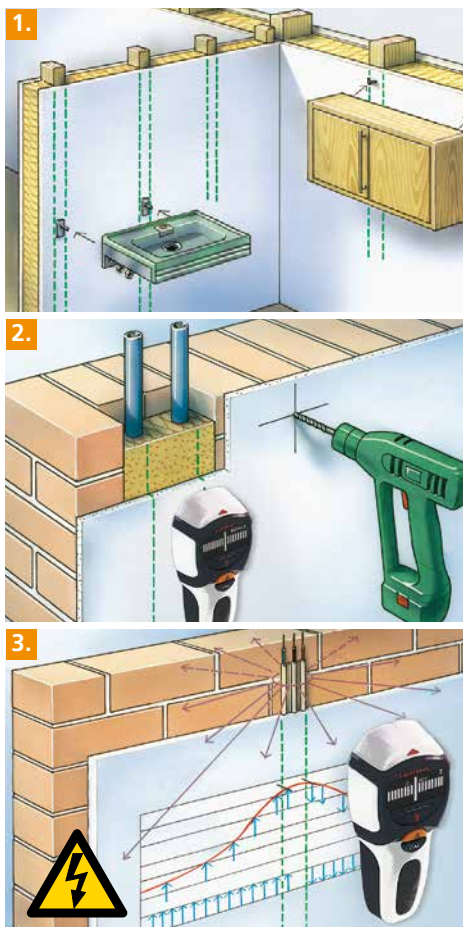

- Several integrated sensors make the MultiFinder Plus a scanning and detection tool for many different applications.
- One-button operation to switch between the different measurement modes
- The user guide on the LC display makes the MultiFinder Plus easy and reliable to use.
- Auto-Calibration: adjusts the device to different surfaces immediately after switching on.
- Auto-Cal Plus: allows objects to be localized easily in Metal-Scan mode.
- Acoustic and visual detection signals for finding objects.
- High safety is guaranteed by the permanent voltage warning function.
- Special feature: in metal mode, it is even able to detect concealed lines when they are not live.

TECHNICAL DATA

DETECTION RANGE AC 110 - 230V, 50 - 60 HZ
OPERATING CONDITIONS 0°C ... 40°C , Max. humidity 80% rH, no condensation, Max. working altitude 2000 m above sea level
STORAGE CONDITIONS -20°C ... 70°C, max. humidity 80% rH
POWER SUPPLY 1 x 9V alkali battery (type 6LR 61)
DIMENSIONS (W x H x D) 80 x 186 x 40 mm
WEIGHT (incl. battery) 230 g

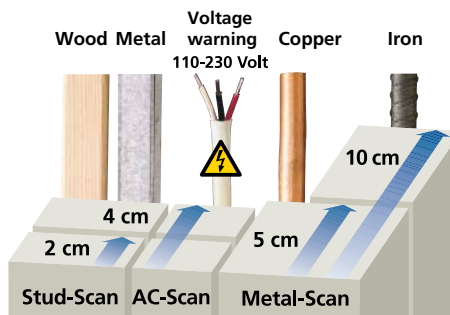

MultiFinder Plus
+ battery
Packing dimension (W x H x D)
190 x 310 x 80 mm

OVERVIEW

1 Wood/metal beam location (Stud-Scan)	Up to 4 cm depth
2 Targeted metal location: Ferro-Scan/ Non-Ferro-Scan (Metal-Scan)	Up to 10 cm / up to 5 cm depth
3 Targeted location of live supply lines (AC-Scan)	Up to 4 cm depth
Location of dead supply lines	Up to 4 cm depth
Automatic calibration	Yes
Permanent voltage warning	Yes
Display	Illuminated LC-display
Detection and warning information	Visual and audible

ARTICLE	ARTICLE NO	EAN-CODE	PU
MultiFinder Plus	080.965A	4 021563 684175	5

